

# BOLT BAG #41200

## CANOPIES: 20', 22', 24', 26' 28', 30'

**DAKA CORPORATION**  
 955 INDUSTRIAL ST NE, PINE CITY MN 55063  
 OFFICE: 320-629-6737 / FAX: 320-629-3677

### CANOPY INSTRUCTION MANUAL

KEY#	DESCRIPTION	PART #	QUANTITY
1	Canopy Bows	83852084 & 2096 / 83820115 & 0120	<i>see lengths below:</i>
		20' (9) / 22' (10) / 24' (11) / 26' (12) / 28' (13) / 30' (14)	
2	Canopy End Frames	2084EFRS / 2096EFRS / 2062EFRS / 2062EF120	2
3	Center Connection Tube	83852085 22" long (in #41200 bolt bag)	1
4	Canopy Rail Assembly, Right	49009RRH / 49011RRH / 49013RRH / 49015RRH *	2
5	Canopy Rail Assembly, Left	49009RLH / 49011RLH / 49013RLH / 49015RLH *	2
6	Ridge Tube	49009RID / 49011RID / 49013RID / 49015RID	2
7	Canopy Cover (not shown)	Various size/color	1
8	Canopy Legs	49055 / 49050D / 49015 (std)	4
9	(Number not used)		

**BOLT BAG #41200:**

3	Center Connection Tube	83852085 (22" long)	1
10	Canopy Rail Splice Tube	41200210 (22" long)	2
12	Hose Clamp	HC58418	4
	Instructions – standard canopy	66886000	3 pgs.
	Plastic Bag (10" x 30")	69660040	1

**BOLT BAG #41215:**

11	Corner Protectors, Tape	41200211	4
13	S-Hooks 3/16 (not shown)	82831030	36
15	Carriage Bolt ¼ x 2¼	CB14214	14
16	Cap Nut ¼	CPN14	14
17	Flat Washer ¼"	FW14sae	14
18	Hex (Set) Bolt ½ x 1 ½	HB12112	14
19	Square Nut	NS12	14
	Plastic Bag	69660027	1
	14 & 20 (Numbers not used)	-	

Shock Cord (inc. w/cover)                      SC38 (84"-50', 96"-55'/60', 115" & 120"-55'/60'/65'/70'/75'/80')                      1

**\* COMBINE 1 OF EACH SIDE RAIL SET SHOWN ABOVE TO MAKE THE FOLLOWING LENGTHS:**

20': ONE (1) 9' & ONE (1) 11'	26': TWO (2) 13'
22': TWO (2) 11'	28': ONE (1) 13' & ONE (1) 15'
24': ONE (1) 11' & ONE (1) 13'	30': TWO (2) 15'

**#2063CBK CANOPY BRACE KIT BOLT BAG #41210 – PACKED SEPARATELY  
 (26' & 28': 1 BRACE KIT; 30': 2 BRACE KITS)**

## CANOPY INSTRUCTION MANUAL

1. Lay canopy rail assemblies (Key 4 & 5) on level surface. Join the two right side pieces together and the two left side pieces together by inserting the canopy rail splice tubes (Key 10) into the center of each. The splice tubes are held in place by 2 set bolts and square nuts (Key 18 & 19 - see Detail A).  
[**Note:** Make sure to join the two ends of the canopy rail assemblies together that are labeled “center”. Pegs should be no more than 24” apart at center splice location. If they are, the rails are not assembled correctly.]
2. Place canopy bows (Key 1) onto pegs on canopy rail assemblies. [NOTE: At this time make sure that pegs on canopy rail assemblies (Key 4 & 5) are offset towards the outside of the canopy frame. Also, make sure bows are slid all the way down on pegs].
3. After installing canopy bows, install ridge tube (Key 6). Start at the center splice by inserting center connection tube (Key 3) into one end of each ridge tube. Insert carriage bolt (Key 15) through canopy bow and then down through ridge tube. [NOTE: Make sure ridge tube is under canopy bows and that carriage bolt is pointing down with cap nut (Key 16) under].
4. Attach the 2 canopy end frames (Key 2) to the canopy rail assemblies (Key 4 & 5). Secure with set bolts and square nuts (Key 18 & 19 - Detail A).
5. Install rubber corner protectors (Key 11) on the 4 outside corners of canopy rail assembly.
6. Place canopy legs (Key 8) into lift legs and level. Make sure top angle on leg is on outside of canopy rail assembly. (i.e., open to inside of lift).
7. Lift canopy frame into position, placing on top of lift legs.
8. Place hose clamps (Key 12) around top angle on canopy legs and around canopy side rails from the outside facing in. Securely tighten hose clamps.
9. Remove canopy cover (Key 7) from carton and place on top center ridge tube of one end and roll to the other end. Unfold canopy cover out to both sides. Be sure to center canopy cover on frame, end-to-end and side-to-side. Loosen set bolt on canopy end frames (Key 2) and push frame out to create a snug fit. Retighten set bolts.
10. Thread shock cord through ‘D’ rings all the way around. Tie the two ends together or to the same ‘D’ ring (usually in a corner). Be sure shock cord tension is distributed evenly around perimeter of frame.
11. Using ‘S’ hooks, fasten the shock cord to each canopy bow. Start on the side, alternating between sides to evenly tension the canopy. Use all available “S” hooks.  
**IMPORTANT:** To achieve the best fit and appearance of the canopy cover, make sure the shock cord is routed as shown in the photo below. The shock cord should never be installed so that it runs diagonally from the S hook downward. Doing so will cause the canopy cover to appear wrinkled. **The cord should always run straight up and straight across to the next S hook.** This will greatly improve the appearance and fit of your canopy.

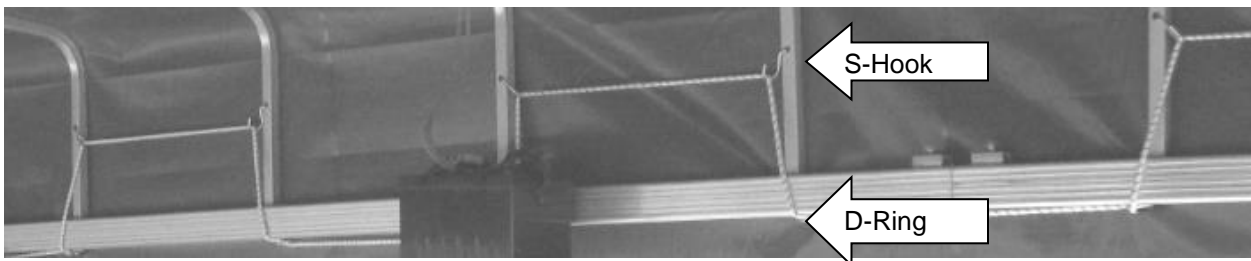

12. If cleaning your canopy cover becomes necessary, use mild soap and warm water. Do not use detergents, solvents or bleach. Do not fold up or store canopy cover when wet. Always allow to air dry completely.

# BOLT BAG # 41200 CANOPY ASSEMBLY



955 INDUSTRIAL STREET N.E. PINE CITY, MN 55063  
320-629-6737 (OFFICE) \* 320-629-3677 (FAX)  
www.dakadock.com

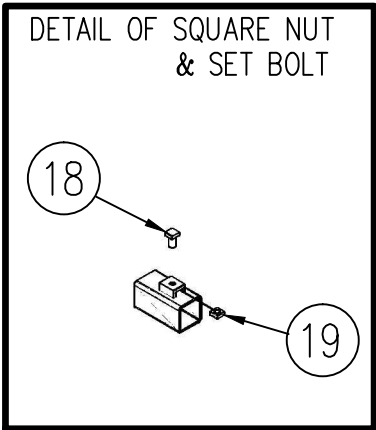

7 Canopy Cover (not shown)

